

Please visit our YouTube channel for all the **set up videos** at: <http://www.youtube.com/user/wheelstandpro>

Thrustmaster F458, SPIDER, T80, T100, RGT, F. RED LEGEND set up video

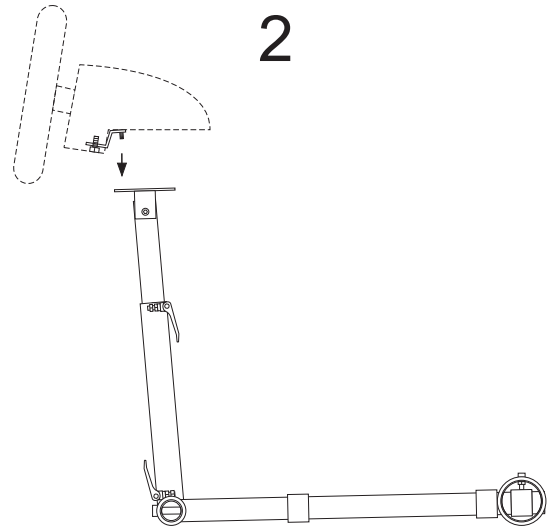

Thrustmaster (F458, T80, T100, SPIDER, RGT, F. GT EXPERIENCE) adapter holes

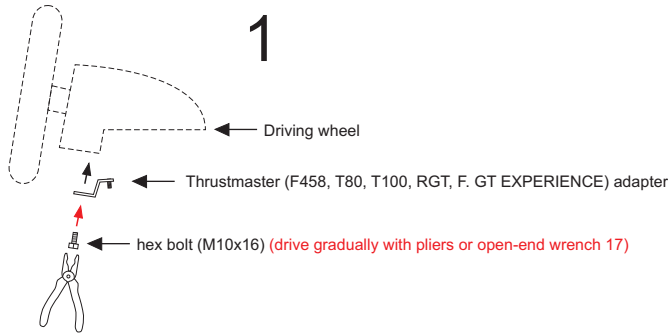
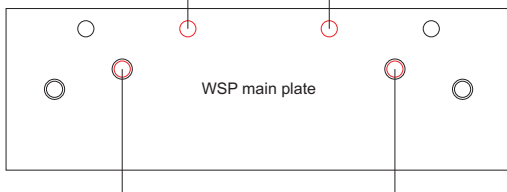

Thrustmaster F430, TX, T300RS mounting holes

Thrustmaster F430, TX, T300RS, wheels are mounted with 2 Allen screws (M6x16) only. Adapter is not necessary.

Tightening the screws too much can cause damage to the wheel and pedals.

Thrustmaster 2014/2015 pedals fastening video (standard 2-pedals set)

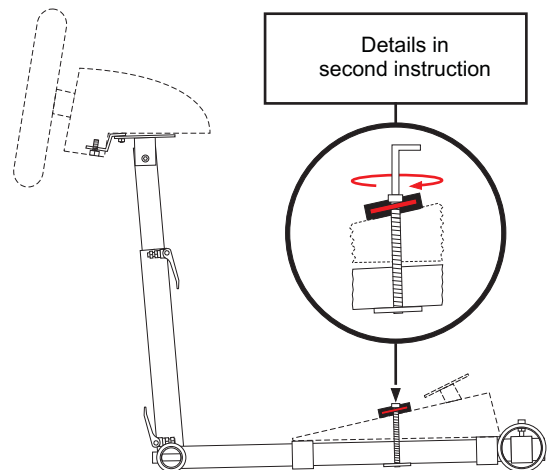
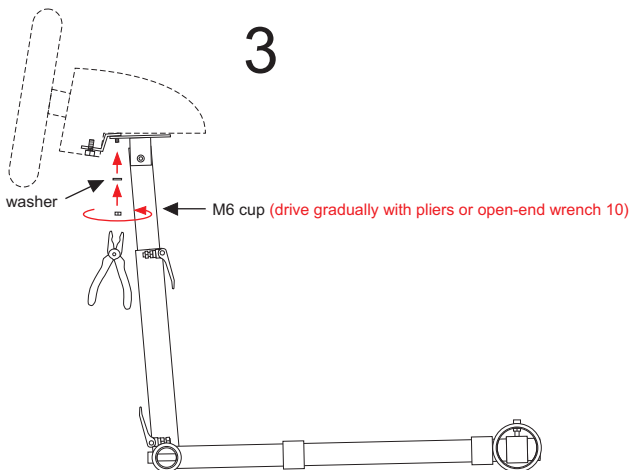

PLEASE ALSO VISIT CONSTRUCTOR'S TIPS: <http://www.wheelstandpro.com/contips.html>

www.wheelstandpro.us

Thrustmaster and T300RS are trademarks of Guillemot Corporation S.A. F430 is trademark of Ferrari S.p.A.