



wheel stand pro

Maintenance

- Let loose joint before making any adjustments
- Keep this product in a dry environment free of chemical substances and vapour
- Never screw home stronger than necessary. You can damage the thread or/and bolt
 - Clean it with a dry cloth

For better stability place both feet on the pedals.

Logitech
2014/2015 pedals fastening video
(standard 2-pedals set)



Thrustmaster
2014/2015 pedals fastening video
(standard 2-pedals set)

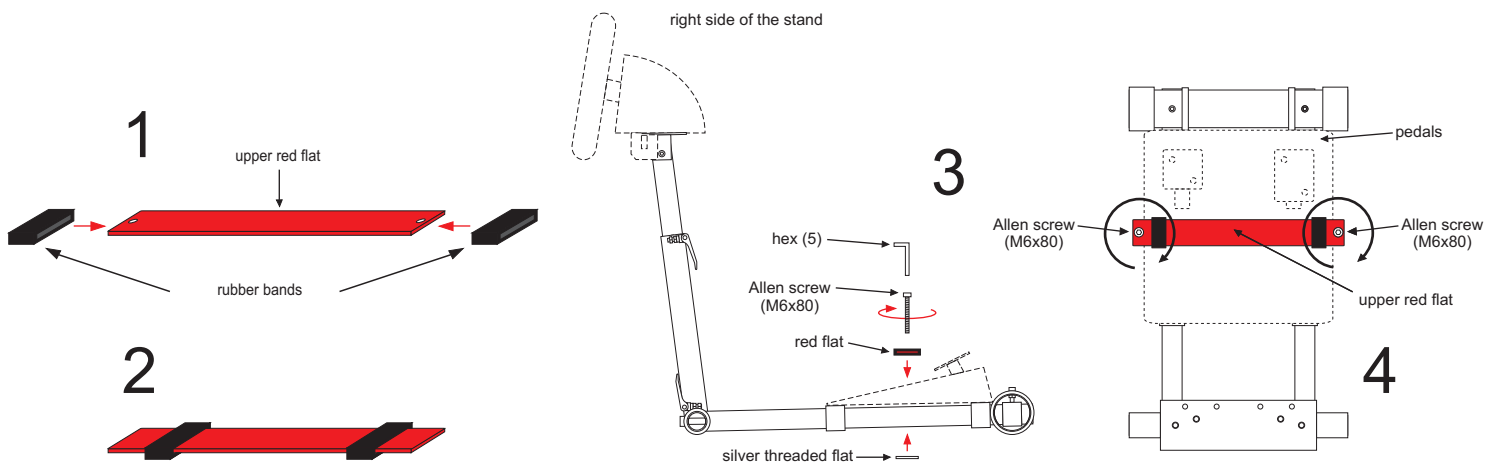

In the box:

- 1 wheel stand pro unit, 1 red flat, 1 silver threaded flat, 1 hex wrench 5, 1 hex wrench 6, 1 open-end wrench 13
- 2 Allen screws (M6x16 for F 430 wheel), 2 Allen screws (M6x80), 2 rubber bands, 2 bands, 1 instruction

Warranty

Wheel stand pro offers two year warranty from the date of purchase.

This warranty is available to the original owner by returning this paper.

- Warranty coverage includes all parts and workmanship
- Warranty is void if damage is due to abuse, neglect or modification
- Cost associated with the return of this product is the sole responsibility of its owner

In case of any problems with your product please contact us at order@wheelstandpro.com

Tightening the screws too much can cause damage to the wheel and pedals.

For details please visit our website

www.wheelstandpro.us